

## XL MOTORS

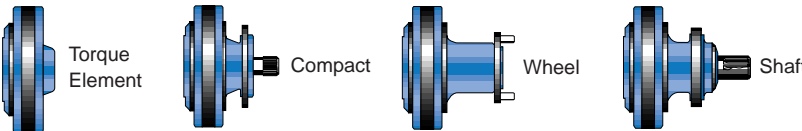
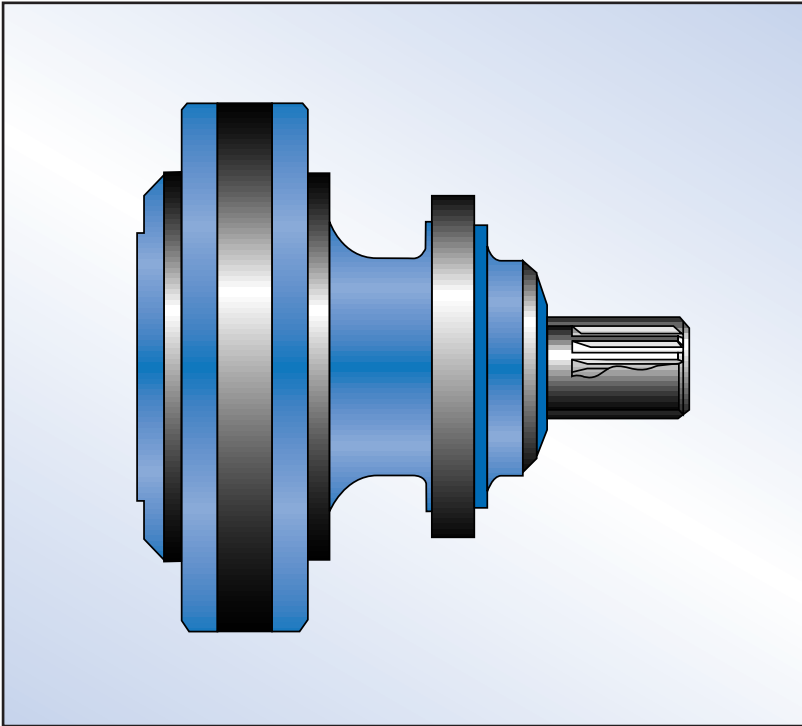

### FEATURES

- Selection of closely spaced displacements available.
- Compact, robust design.
- 4 type options:
  - Torque Element
  - Compact motor
  - Wheel motor
  - Shaft motor
- Smooth rotation at low speeds.
- Low operating noise.
- Reversible.
- Taper roller bearings.
- High radial forces permitted on output shaft.
- Shaft seals for up to 7 Bar housing pressure.
- Freewheeling.

### SPECIFICATION

#### Fixed displacement motor

Size: 150...1120cc/rev.

Radial piston, multi-stroke, cam type motor.

High pressure capability, with peak pressure to 420 Bar.

**For further information consult ROTARY POWER.**

### PERFORMANCE DATA

Model	Size cc/rev	Max Continuous Speed rev/min	*Max Continuous Pressure Bar	Max Freewheel Speed rev/min	Max Continuous Power KW	Specific Torque Nm/100 Bar
150	150	550	210	1000	18	239
200	200	500	210	1000	18	318
280	280	390	210	1000	18	446
390	390	440	210	850	30	621
490	490	350	210	850	30	780
560	560	320	210	850	30	891
780	780	230	210	850	60	1242
880	880	200	210	850	60	1401
980	980	180	210	850	60	1560
1050	1050	170	210	850	60	1672
1120	1120	160	210	850	60	1783

\* Intermittent pressure rating 350 bar. Peak pressure rating 420 bar.