

**A RANGE AXIAL PISTON PUMPS AND MOTORS**

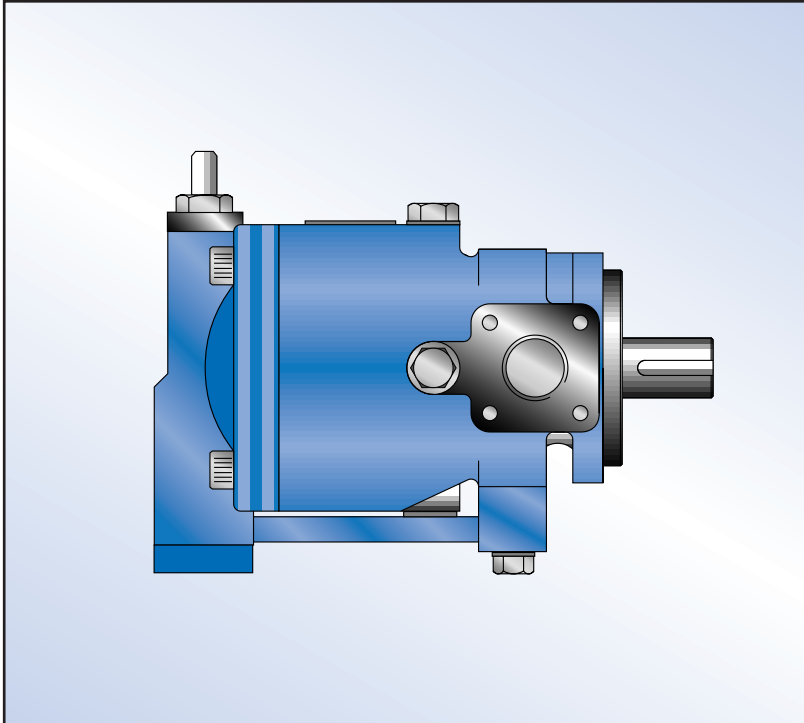

**FEATURES**

- Suitable for most hydraulic fluids:  
Hydraulic mineral oils.  
HFA – Water emulsions, 95/5.  
HFB – Water emulsions, 60/40.  
HFC – Water glycols.  
HFD – Phosphate esters.  
Diesel, Paraffin.  
Other special fluids.
- Large range of manual, semi-automatic and fully automatic controls:  
Fixed displacement.  
Manual control.  
Servo control.  
Constant pressure.  
Load sensing.  
Constant power.  
Combination controls.

**SPECIFICATION**

**Axial piston pumps and motors.**

Size: 0...125cc/rev.

Open loop type.

Continuous pressure 320 Bar.

Special fluids.

**For further information consult ROTARY POWER.**

**PERFORMANCE DATA**

Model	Size cc/rev	Max Continuous Speed rev/min	Max Continuous Pressure Bar	*Specific Flow litres/min	**Approx. Weight	Specific Torque Nm/100 Bar
A70	11.5	4000	320	46	5	18.3
A200	33.0	3500	320	115.5	10.9	52.5
A380	62.0	3000	320	186	27.7	98.7
A560	92.0	3000	320	276	35	146.5
A760	125.0	2500	280	312.5	64.1	199.0

\* Theoretical – Maximum rpm.

\*\* Quoted for fixed displacement pumps/motors.

Note: The performance information quoted above applies to operation on mineral oil. Consult ROTARY POWER for operational criteria for other fluid types.